

DIAMOND FILES A2

DIAMOND FILES

- ELECTRO DEPOSITED DIAMOND FILES
- PRECISION GRADED PARTICLE SIZE (68-28 MICRON)
- EXCELLENT FOR FINISHING SLOTS, SIDEWALLS, FLAT OR CURVED SURFACES
- USED FOR INTERMEDIATE FINISHING
- FAST CUTTING

PART NO.	MESH
SE5845	200
SE5745	320
SE8851	200
SE7841	200
SE7541	600
SE7741	320
SE3803	200
SE6803	200
SE5832	200
SE9801	200

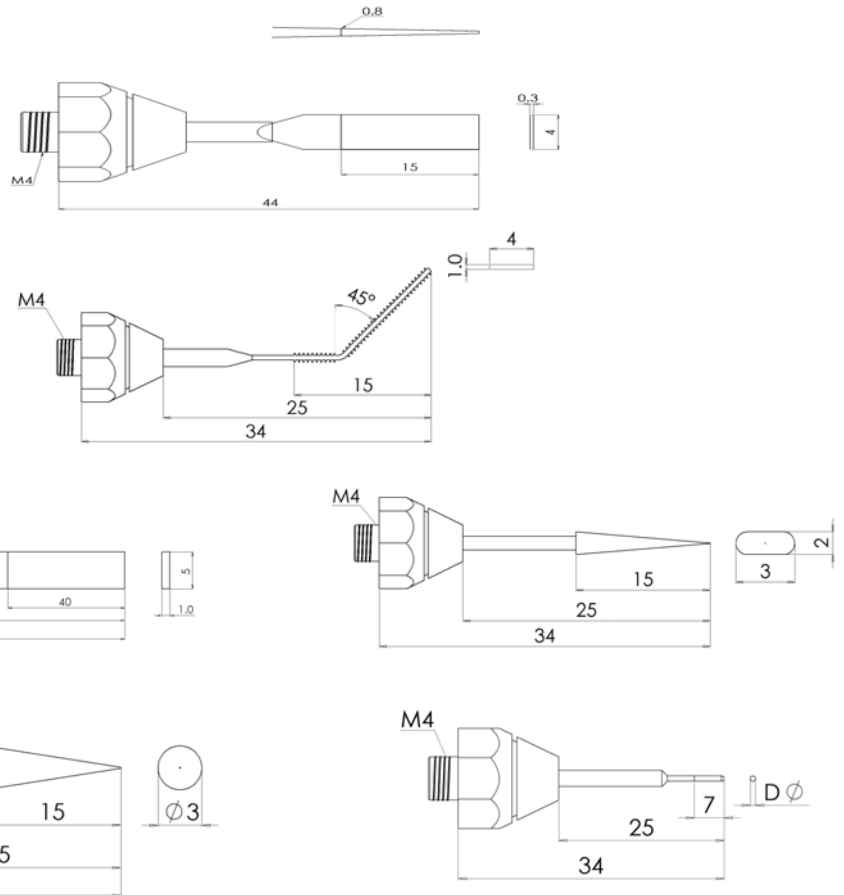

ARGOFILE TOOL CLAMPS

PART NO.	THREAD	TO CLAMP
MX4008	M6 THREAD	0.80mm
MX4110	M6 THREAD	1.00mm
MX4120	M6 THREAD	2.00mm
LX4011	M8 THREAD	1.10mm
LX4012	M8 THREAD	2.10mm

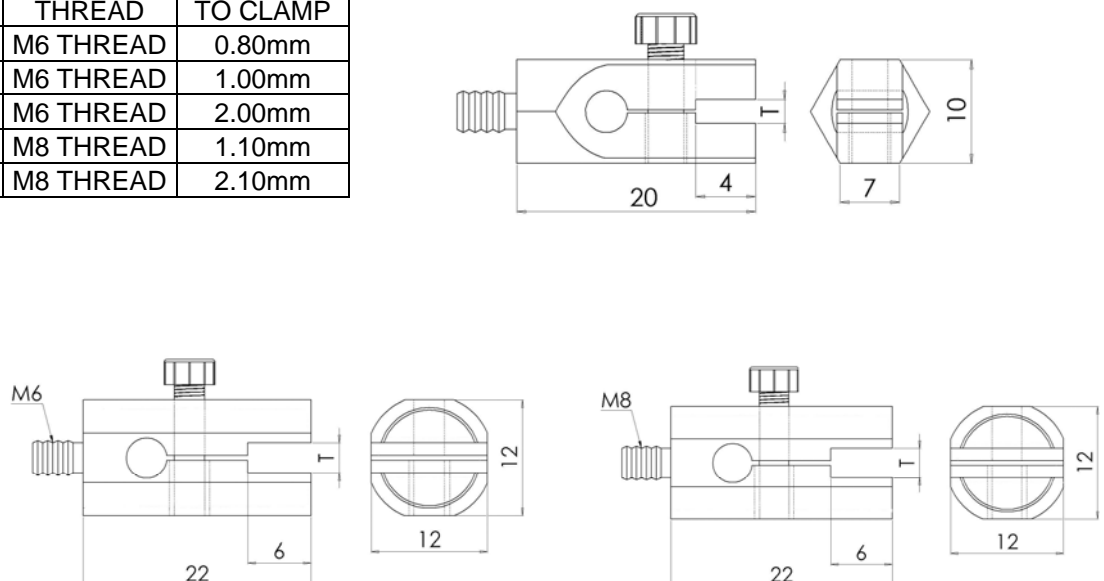

A3 DIAMOND STONES

DIAMOND STONES

- USED FOR INTERMEDIATE AND FINE FINISHING
- PRECISION GRADED PARTICLE SIZE (68-15 MICRON)
- CAN BE SHAPED WITH A DIAMOND FILE TO FINISH INTRICATE SURFACES

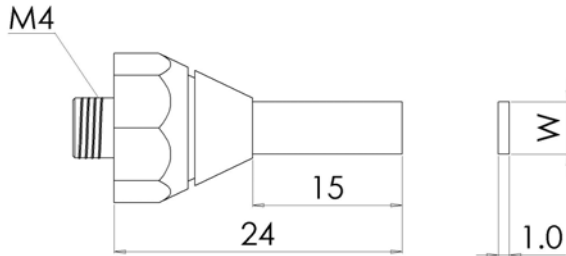

PART NO.	MESH	WIDTH
SD4631	500	3mm
SD4851	200	5mm
SD5851	200	5mm
SD7855	320	5mm
MD8862	200	6mm

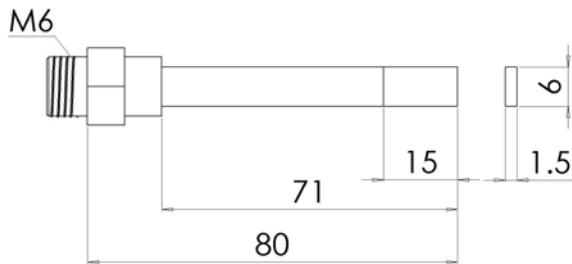
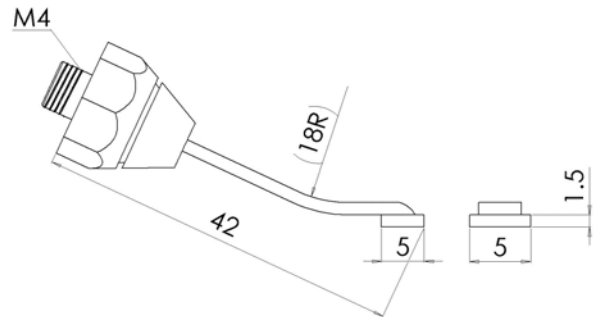
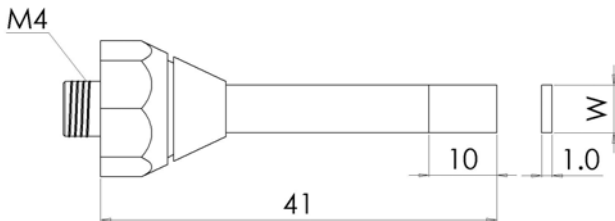

COLOUR CODING

COLOUR	MESH/GRIT	MICRON (nm)
RED	200	68
BLACK	320	40
BLUE	500	35
WHITE	600	28
GREEN	1000	15

DIAMOND FILES

A16

1403S	3 Square	140F41	Flat 4x1	180F	Flat
140B	Barrette	140F	Flat	180HR	Half Round
140C	Crossing	140HR	Half Round	180R	Round
140K	Knife	140R	Round	180RL	Round Long
COMPARISON CHART			Square		

CONGRESS	CESSWEIN	BORIDE	
RES-CUT		AM-8	
E.D.M	E.D.M		
SUPER	NEEDLE	140mm / 180MM	5 piece set
DIE*STAR	RIFFLER	140mm / 180mm	5 piece set
YL-OIL	OIL TREATED	AO	
SUPER SOFT		AS-H	
R-MAX	RA	AB	
FLEX		AB-S	
EXTRA SOFT		CS	
REGULAR	MOLD MAKER	CS-M	
MOLD MASTER		CS-ID	
SUPER FINE	ULTRA SOFT	900F	
NOTE: Because polishing practices may vary these comparisons are only a general guide.			

DIAMOND NEEDLE FILES

CODE	DESCRIPTION	140 LONG	180 LONG
BDF---3S	THREE SQUARE	X	
BDF---B	BARRATTE	X	
BDF---C	CROSSING	X	
BDF---K	KNIFE	X	
BDF---F41	FLAT 4mm X 1mm	X	
BDF---F	FLAT	X	X
BDF---HR	HALF ROUND	X	X
BDF---R	ROUND	X	X
BDF---S	SQUARE		X

DIAMOND NEEDLE FILE SETS

140 LONG 5 PIECES CONSISTING OF F, HR, 3S, S AND R

DIAMOND RIFFLER FILE SETS

5 PIECES 140 LONG AND 180 LONG

DIAMOND HANDLAPS

MESH			
400	800	1200	1800