

## DRILL BUSH WITH COLLAR, DIN 172 SHAPE A

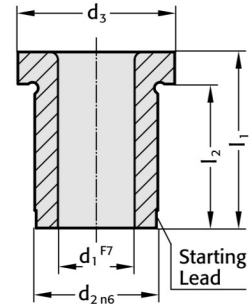

276.



### Material:

Case hardened steel  
Hardness 740 ± 40 HV 10

### Execution:

Diameters  $d_1$ ,  $d_2$  and shoulder precision ground.

Other diameters and lengths on request.

### 276. Drill bush with collar, DIN 172 Shape A

$d_1$	$d_2$	$d_3$	Gradation	$l_1$	6	8	9	10	12	16	20	25	28	30	36	45	56	67
0,9 - 1	3	6	0.1	$l_2$	4		7											
1,1 - 1,8	4	7	0.1		4		7											
1,9 - 2,6	5	8	0.1		4		7											
2,7 - 3,3	6	9	0.1			5.5			9.5	13.5								
3,4 - 4	7	10	0.1			5.5			9.5	13.5								
4,1 - 5	8	11	0.1			5.5			9.5	13.5								
5,1 - 6	10	13	0.1					7		13	17							
6,1 - 8	12	15	0.1					7		13	17							
8,1 - 10	15	18	0.1						9		17	22						
10,1 - 12	18	22	0.1						8		16	21						
12,1 - 15	22	26	0.1							12			24		32			
15,5 - 18	26	30	0.5							12			24		32			
18,5 - 22	30	34	0.5								15				31	40		
22,5 - 26	35	39	0.5								15				31	40		
26,5 - 30	42	46	0.5									20				40	51	
30,5 - 35	48	52	0.5									20				40	51	
35,5 - 42	55	59	0.5											25			51	62

### Ordering Code (example):

Drill bush with collar, DIN 172 Shape A = 2/6.1.

Diameter of conduit  $d_1$  12.1 mm = 1210.

Length  $l_1$  16 mm = 016

Order No = 2/6.1. 1210.016

# DRILL BUSH WITHOUT COLLAR, DIN 179 SHAPE A

277.

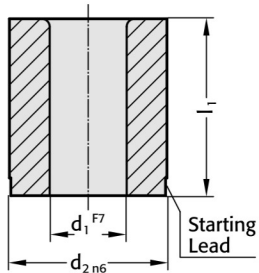

## Material:

Case hardened steel  
Hardness  $740 \pm 40$  HV 10

## Execution:

Diameters  $d_1$  and  $d_2$  precision ground.

Other diameters and lengths on request.

## 277. Drill bush without collar, DIN 179 Shape A

$d_1$	$d_2$	Gradation	$l_1$	6	8	9	10	12	16	20	25	28	30	36	45	56	67
0,9 - 1	3	0.1		●		●											
1,1 - 1,8	4	0.1		●		●											
1,9 - 2,6	5	0.1		●		●											
2,7 - 3,3	6	0.1			●			●	●								
3,4 - 4	7	0.1			●			●	●								
4,1 - 5	8	0.1			●			●	●								
5,1 - 6	10	0.1					●	●	●								
6,1 - 8	12	0.1					●	●	●								
8,1 - 10	15	0.1						●	●	●							
10,1 - 12	18	0.1						●	●	●							
12,1 - 15	22	0.1							●	●				●			
15,5 - 18	26	0.5							●	●				●			
18,5 - 22	30	0.5								●				●			
22,5 - 26	35	0.5								●				●			
26,5 - 30	42	0.5									●			●			
30,5 - 35	48	0.5									●			●			
35,5 - 42	55	0.5										●		●			●
42,5 - 48	62	0.5											●	●			●

## Ordering Code (example):

Drill bush without collar, DIN 179 Shape A	=	277.1.
Diameter of conduit $d_1$	12.1 mm =	1210.
Length $l_1$	16 mm =	016
Order No	=	277.1. 1210.016